

# REDUCED WIRE-TO-WIRE AND JUNCTION BOX 201-01-172

## 1. SPECIFICATION DISTRIBUTION

No restrictions for issue

## 2. SCOPE

This specification contains the application notes for the 9286 poke home wire to wire connector. Both thru wire and junction box versions are included.

## 3. PRODUCTS

00-9286-00X-203-X06 thru wire connectors, (connects pairs of wires) standard colour white.  
00-9286-00X-253-X06 junction box connectors (shorts all wires together) standard colour red.

For wire details refer to product specification 201-01-132.

Note: The connectors in this product series are available in standard white (thru wire version) and red (junction box version).

The colours used in this document are for illustration purposes only.

## 4. PRODUCT RANGE

### 4.1. THRU WIRE CONNECTORS



Available in 1, 2, 3, 4, 5 and 6 way sizes.



### 4.2. JUNCTION BOX CONNECTORS



Available in 4, 6 and 8 way options.

**5. INTERNAL CONNECTIONS**  
**5.1. THRU WIRE CONNECTOR**

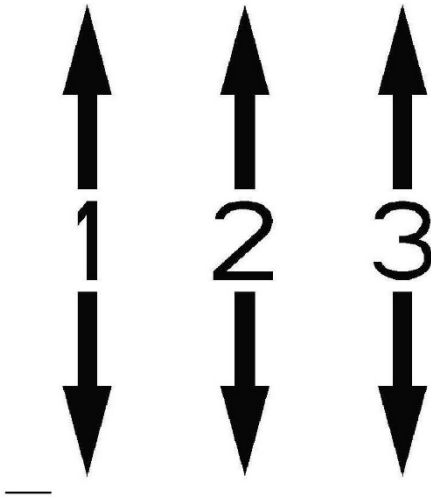

Thru wire connector, internal connection allows a pair of wires – one wire in to one wire out connection only. Each connection is numbered to assist with identification. Connectors available to link 1, 2, 3, 4, 6 and 8 pairs of wires. 3 way shown.

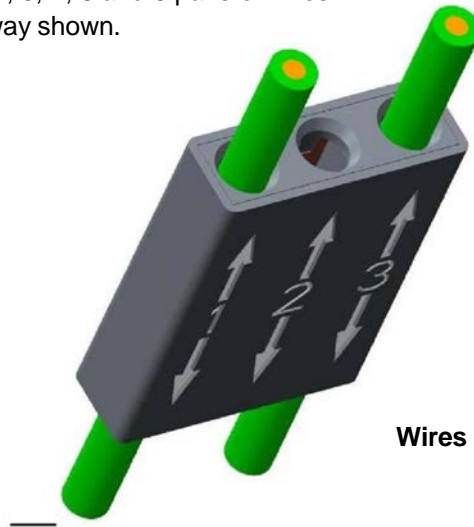

**Wires in pairs, one in and one out.**

**5.2. JUNCTION BOX CONNECTOR**

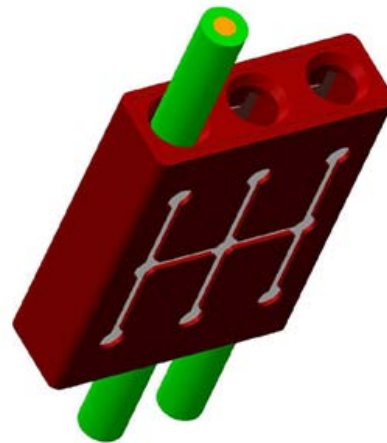
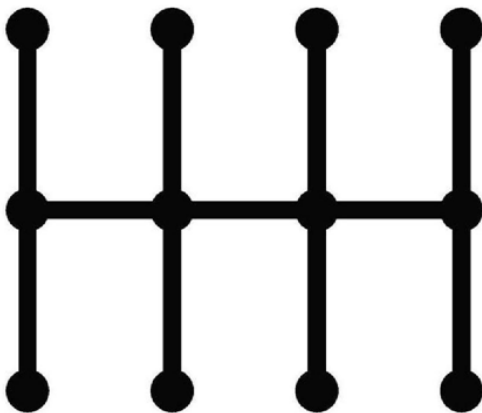

**Wires in any position, all interconnected.**

Junction box connector, internal connection between all wires in/out. Connectors available to inter-connect 4, 6 and 8 wires. 8 way shown.

## 6. WIRE INSERTION – ALL CONNECTORS

### 6.1. WIRE PREPERATION

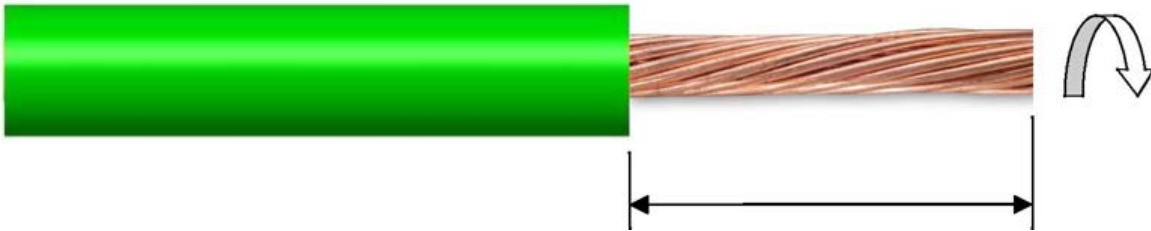

Insulation strip length 3.5mm to 4.5mm.  
Stranded wire – recommended to twist wires together.

Note: for wires with insulation greater than 2.10mm diameter use a strip length 6.5mm to 7.5mm

### 6.2. WIRE INSERTION

1. Standard assembly, insert wires straight into positions required, insulator should always be under-flush with face of connector.
2. When using wire with insulation greater than 2.10mm diameter wire insulation will butt on face of connector.

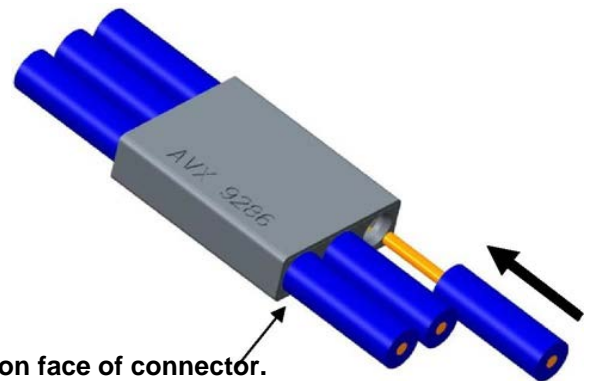
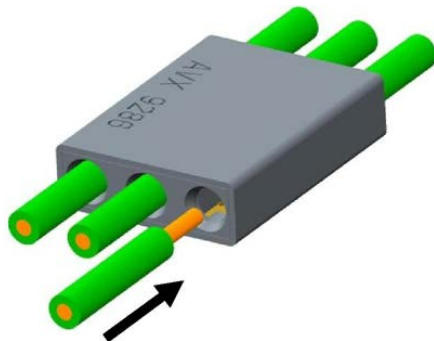

Wire insulation butts on face of connector.

### 7. WIRE EXTRACTION

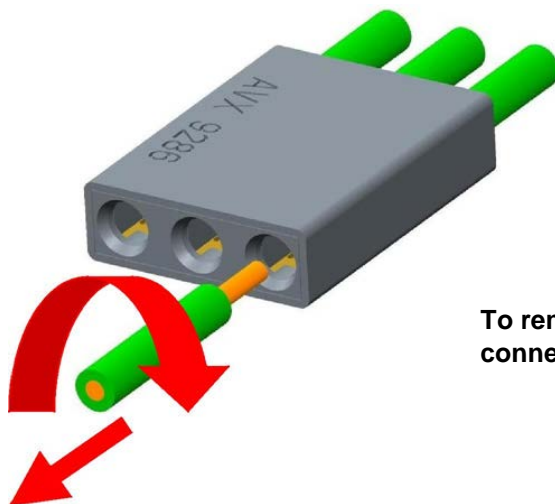

To remove a wire twist and pull in line with connector until wire is free.